

NTNU		Masteroppgave, 2013	
Dato	06.04	Opplagerdetalj Bue	
Prinsipp tegning		Str.	Material
1.1		A3	S355, CE 40L
		Skala	Snitt
		1:1	E-E

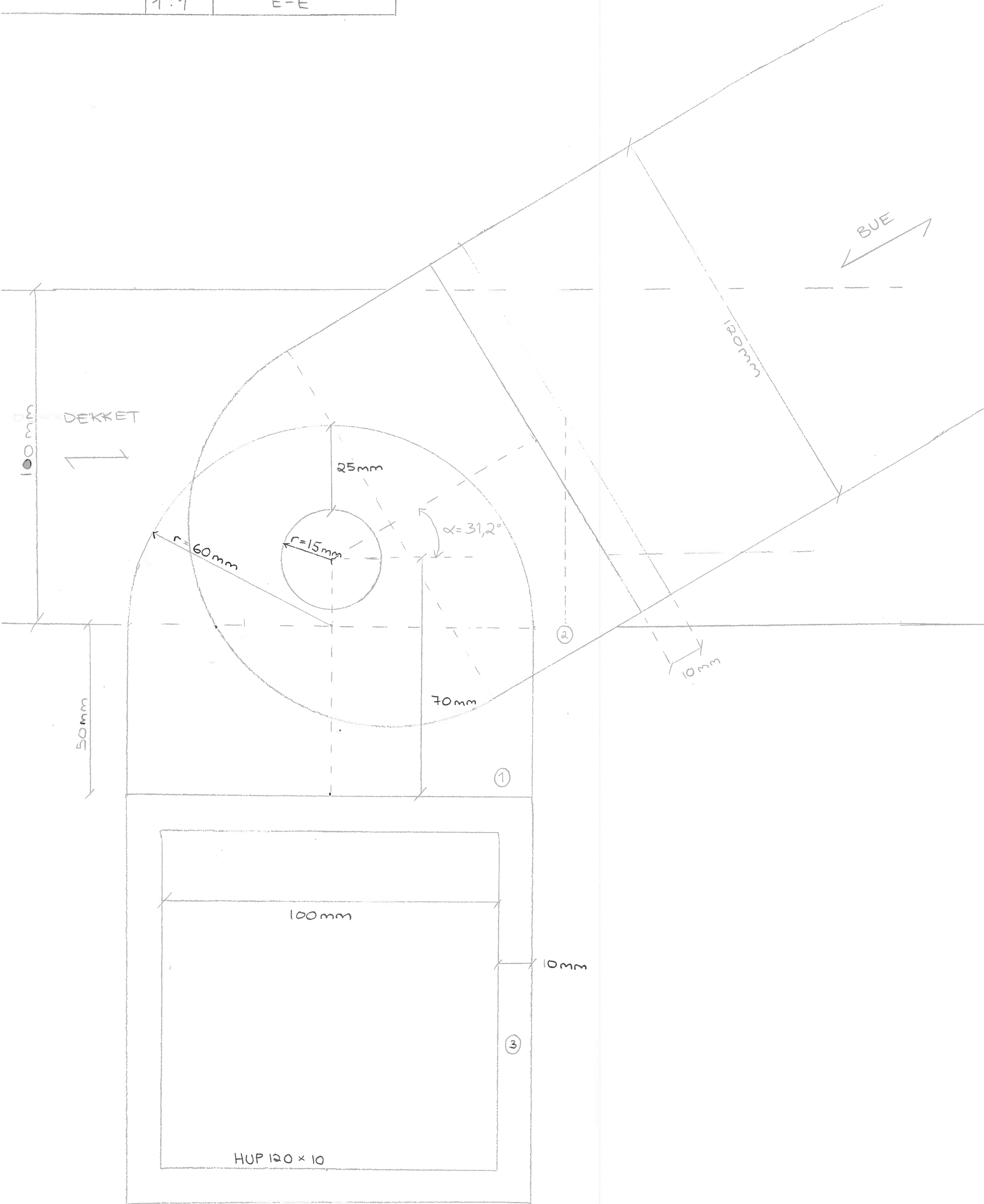

Dato 08.04

Opplagerdetalj,
Dekket ③ ④ ⑤

Prinsipptegning
2.2

Str. A3	Material S355, CE40L
Skala 1:1	Snitt D-D

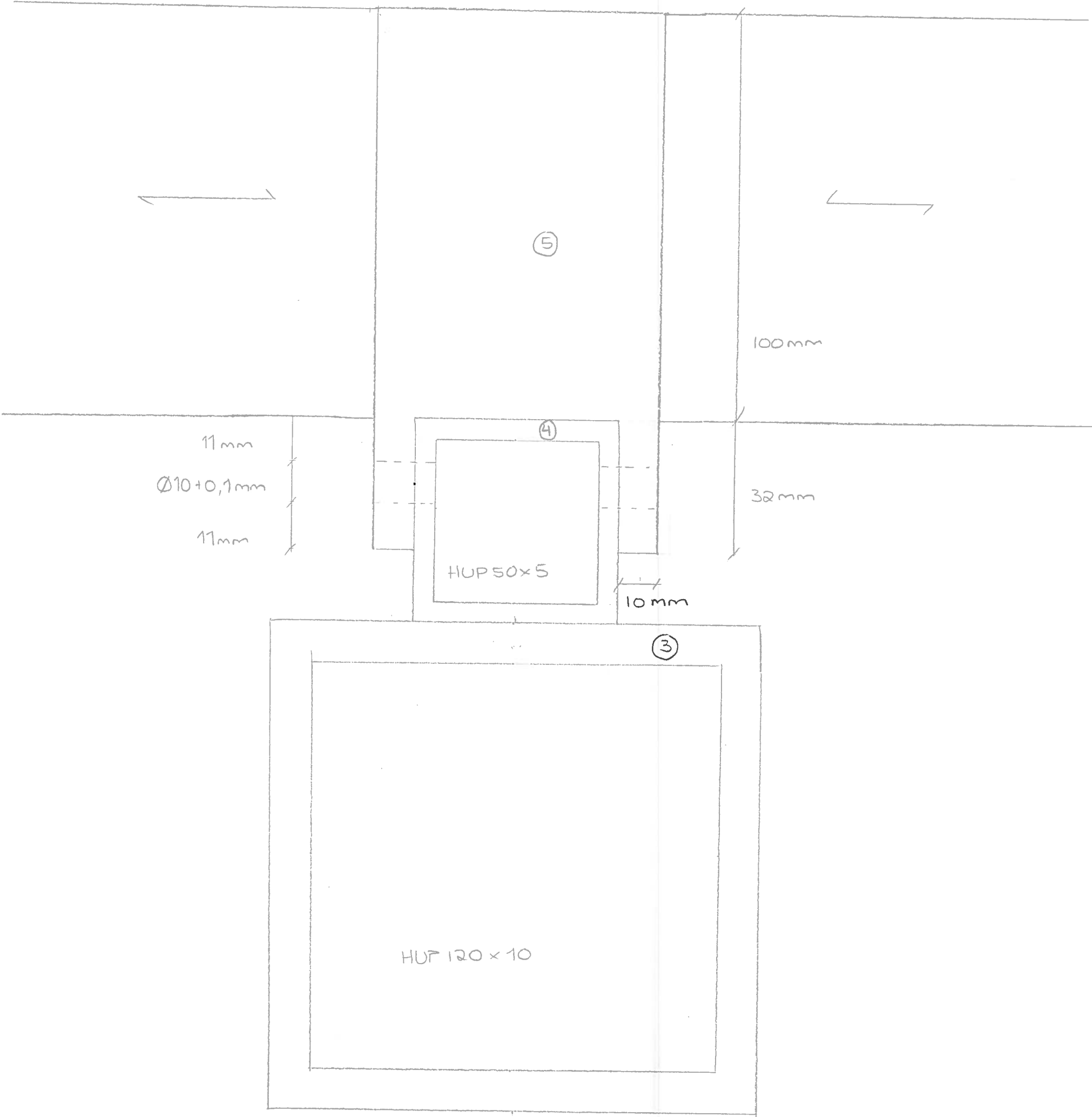

NTNU		Masteroppgave, 2013		
Dato	08.04	Oppløser detalj, Bue		
Tegning 1.1		(2)		
		Str. A3	Material	S355
		Skala 1:1	snitt	H-H

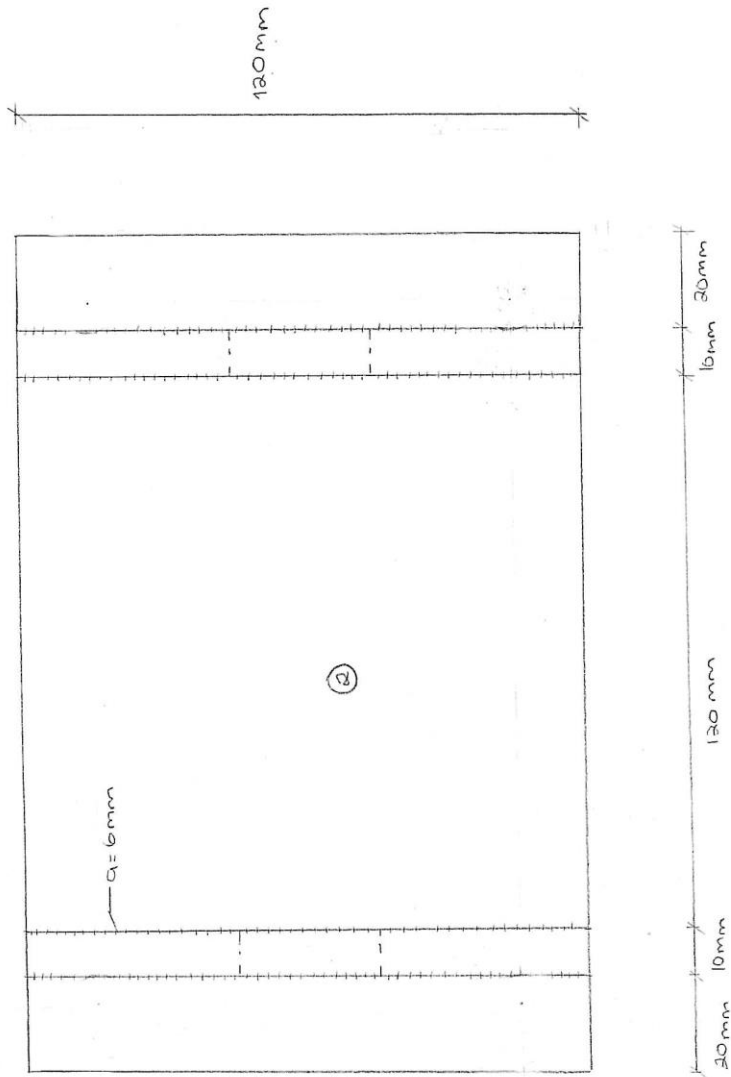

NTNU

Masteroppgave, 2013

Dato 07.04

Oppgaverdetaljer Bue

Tegning 2

① & ③ & ④

Str.

A3

Material

S355

Skala

1:8

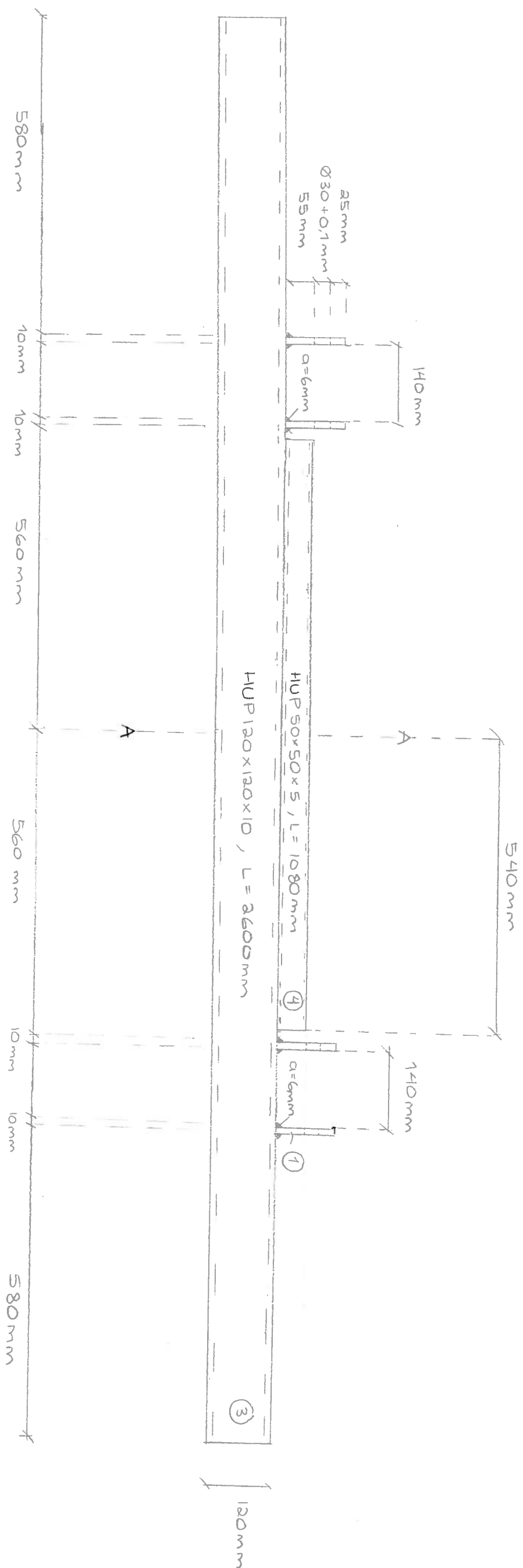



NTNU		Masteroppgave, 2013	
dato 08.04		Opplagerdetalj, Bue ③ & ④	
tegning 2.2			
		Str. A3	Material S355
		Skala 1:1	Snitt A-A

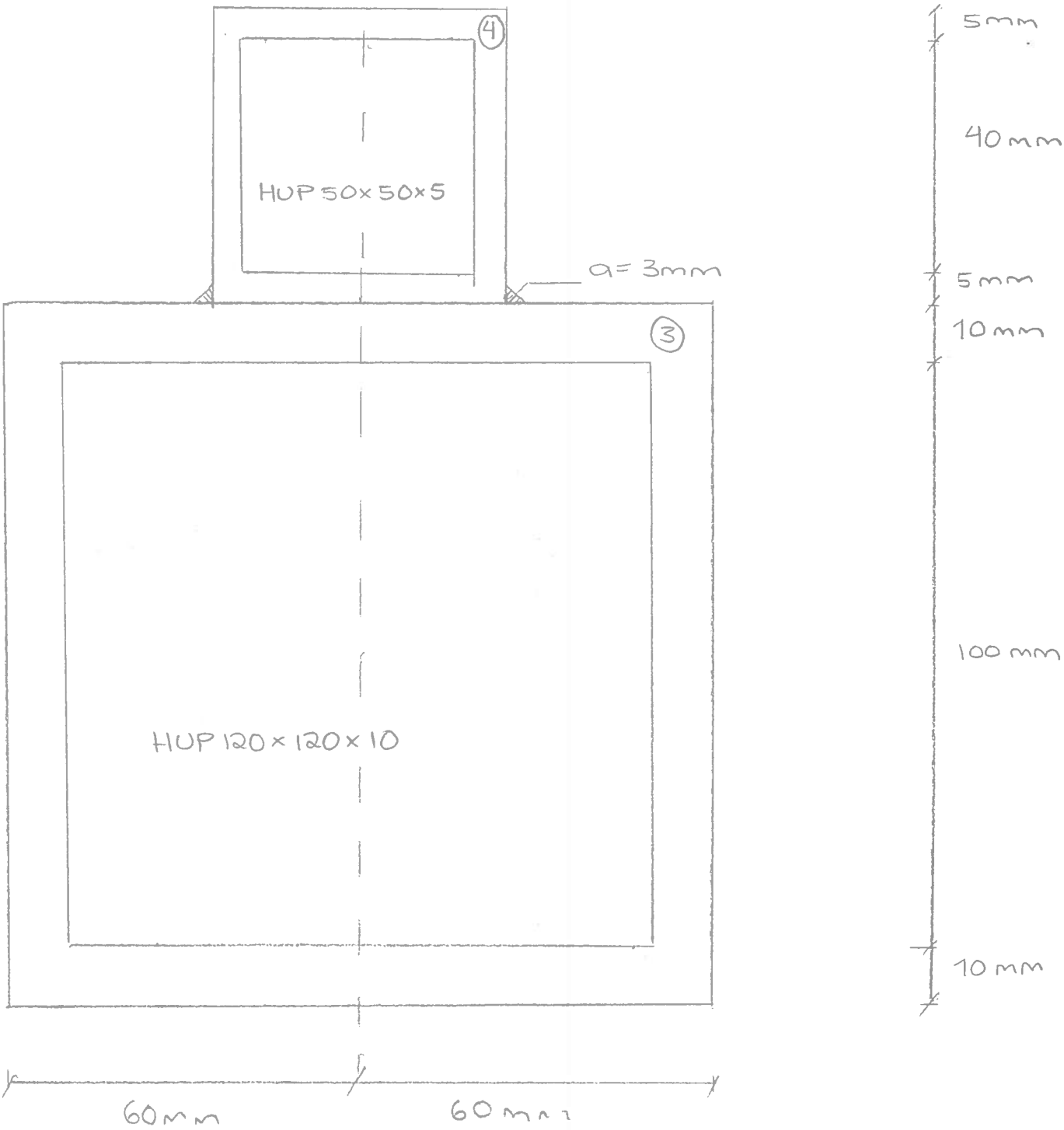

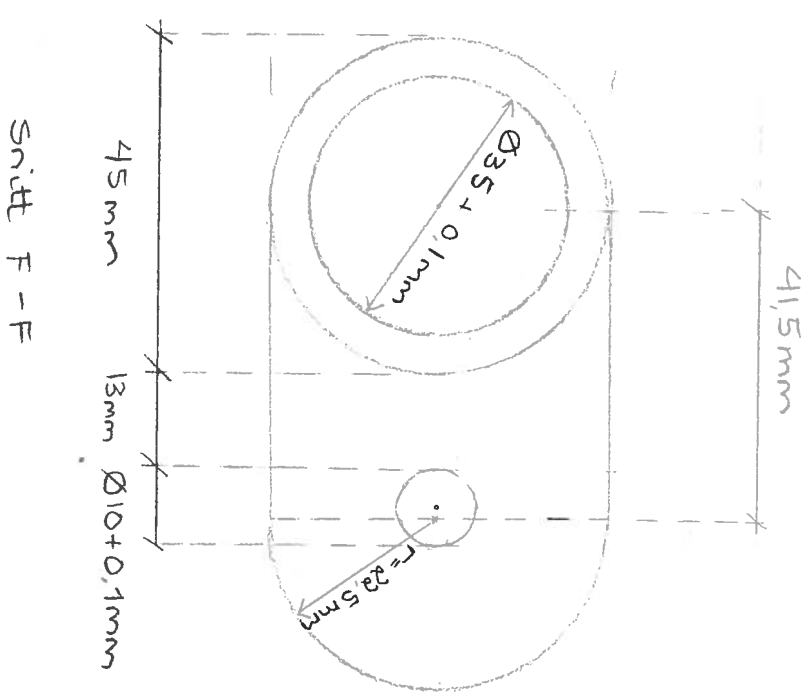
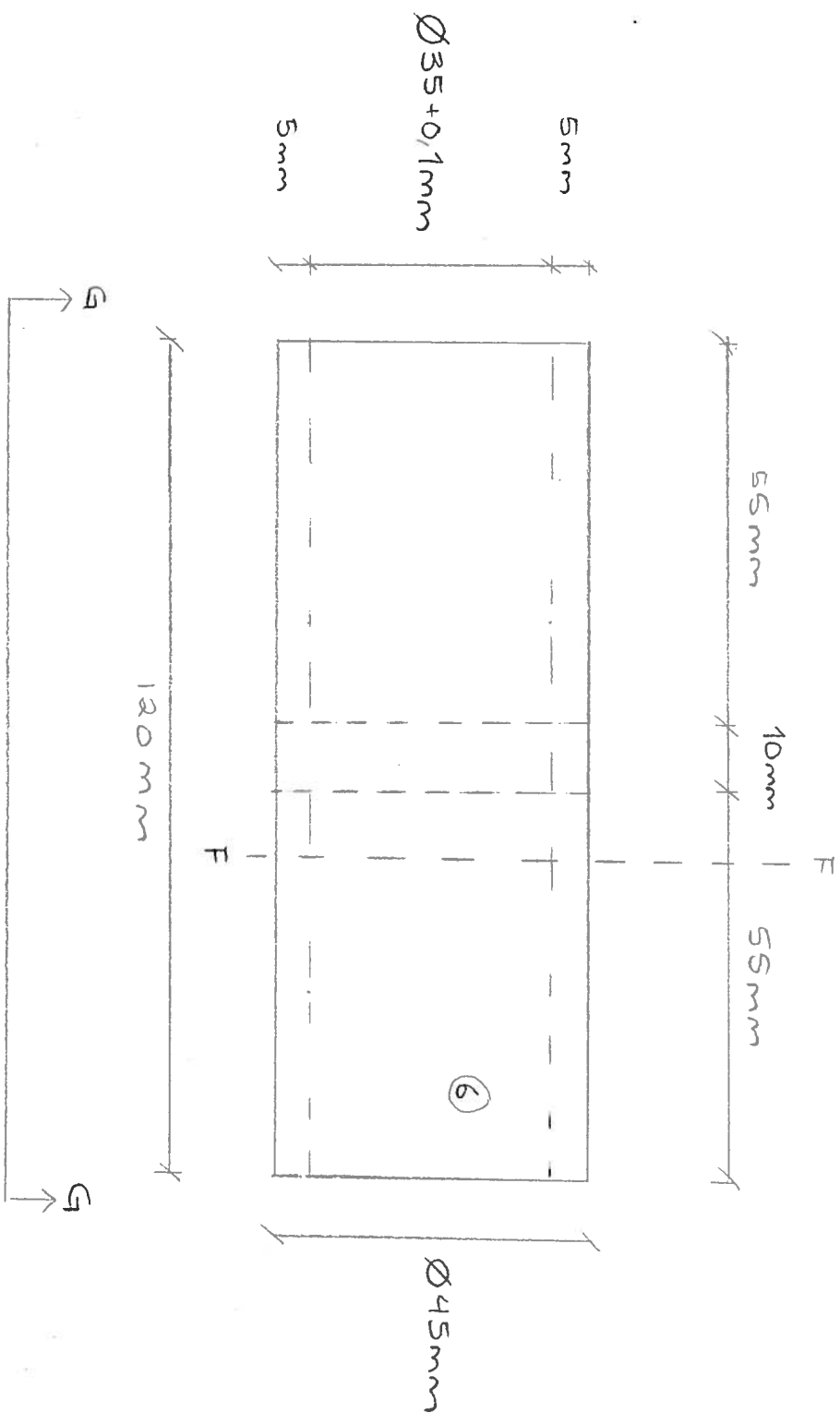
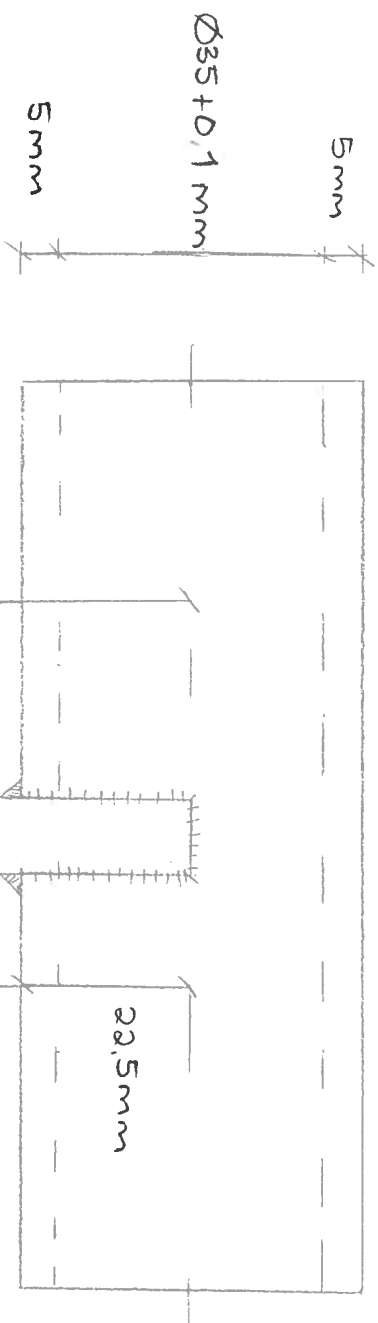

$1:25$ [illegible]

HULL T-PROFILER:

Venster side:

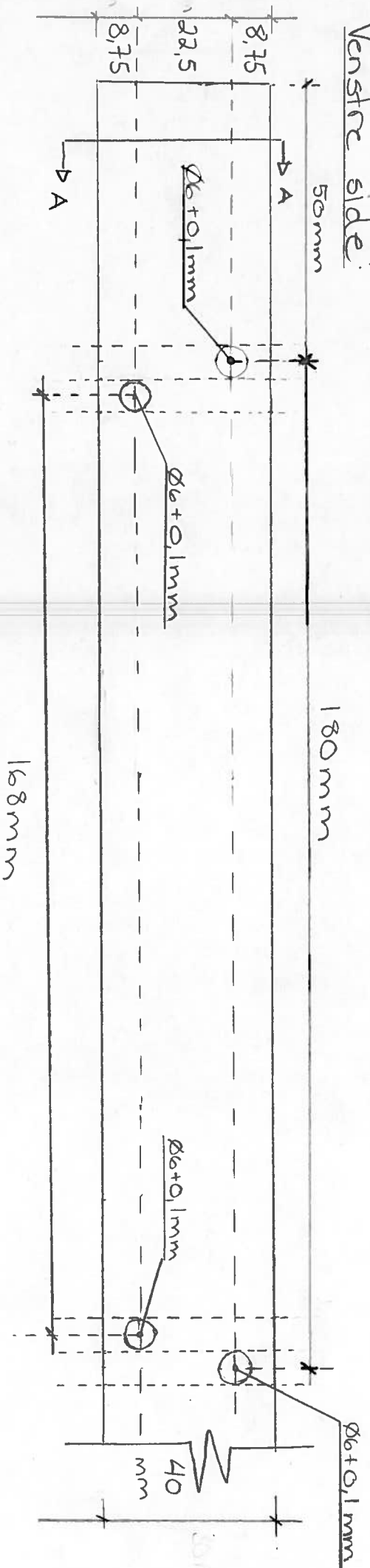

Hege side:

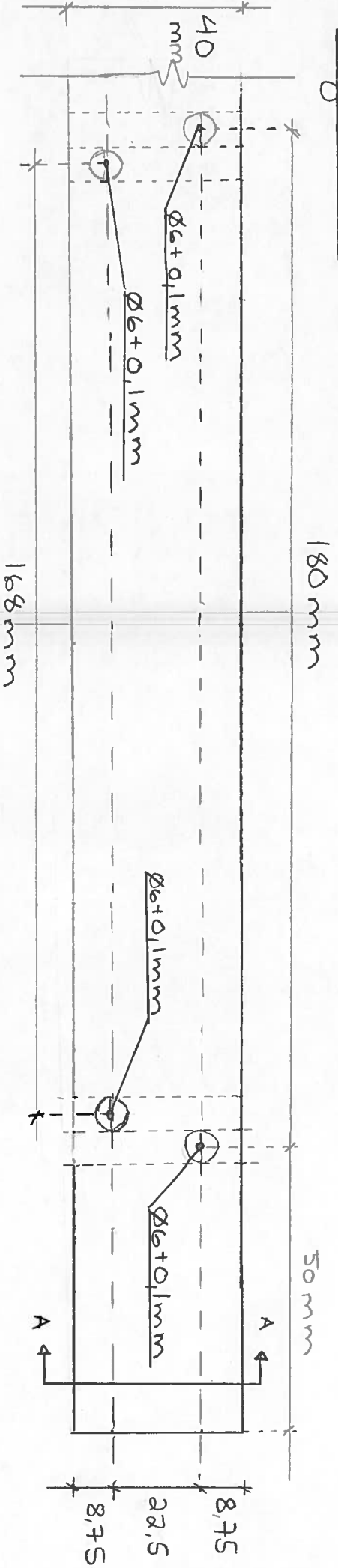

HULL T-PROFILER:

Begge sider:

Snitt A-A:

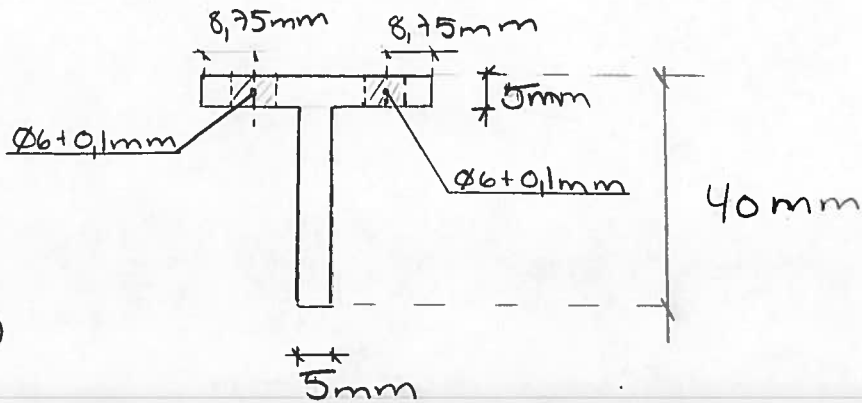

Skala 1:1
Str. A4

LISTESTÅL S235

Navn: Indre
Ant. 46 stk

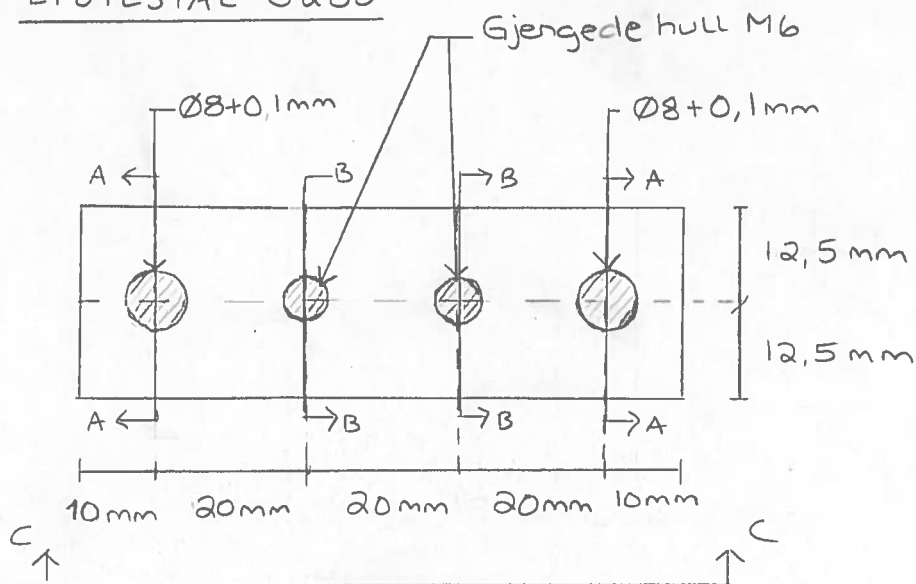

Snitt A-A:

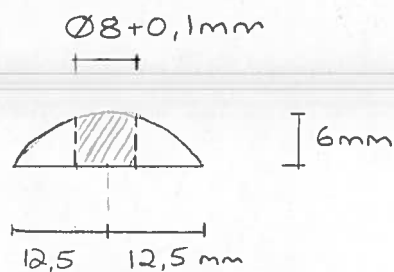

Snitt B-B (gjengede hull)

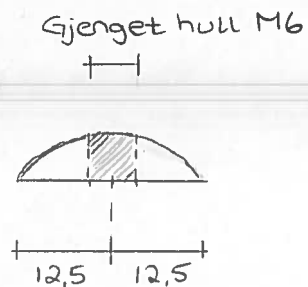

Snitt C-C:

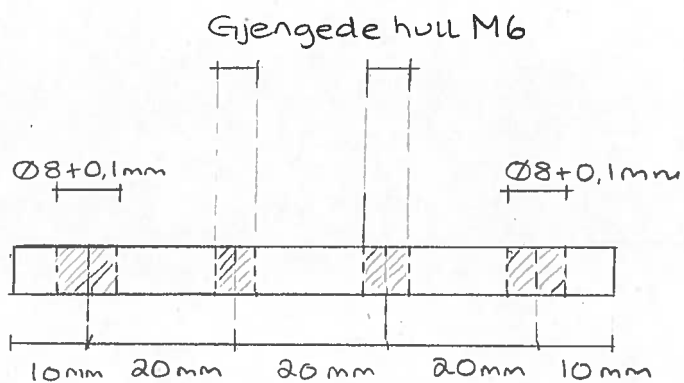

LISTESTÅL S235

Skala 1:1

Str. A4

Navn: Ytre

Antall: 46 stk

Gjenget hull M6

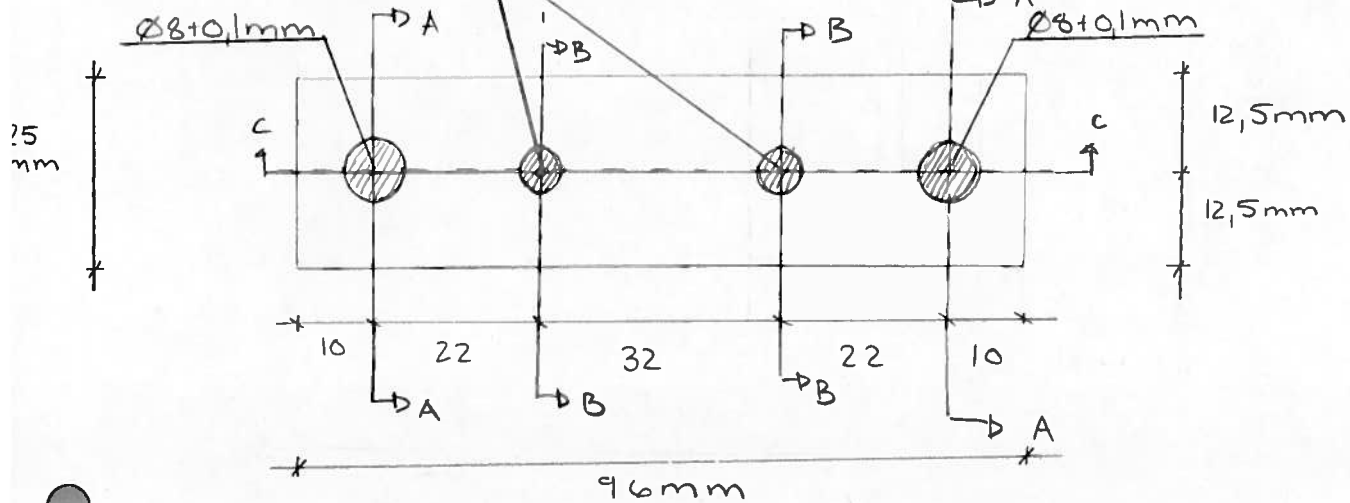

Snitt A-A

Snitt B-B

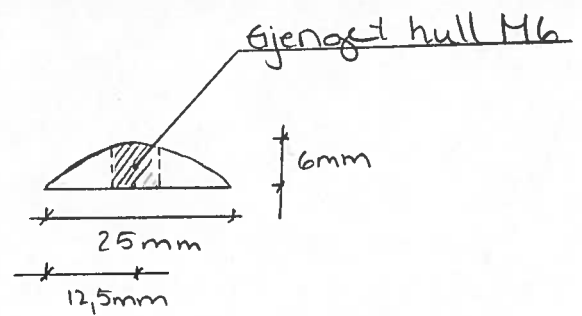
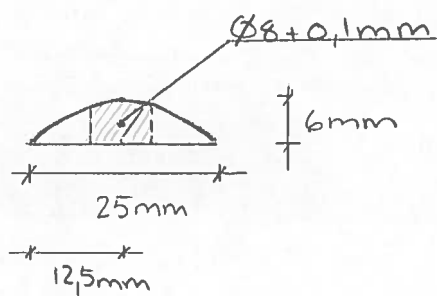

Snitt C-C:

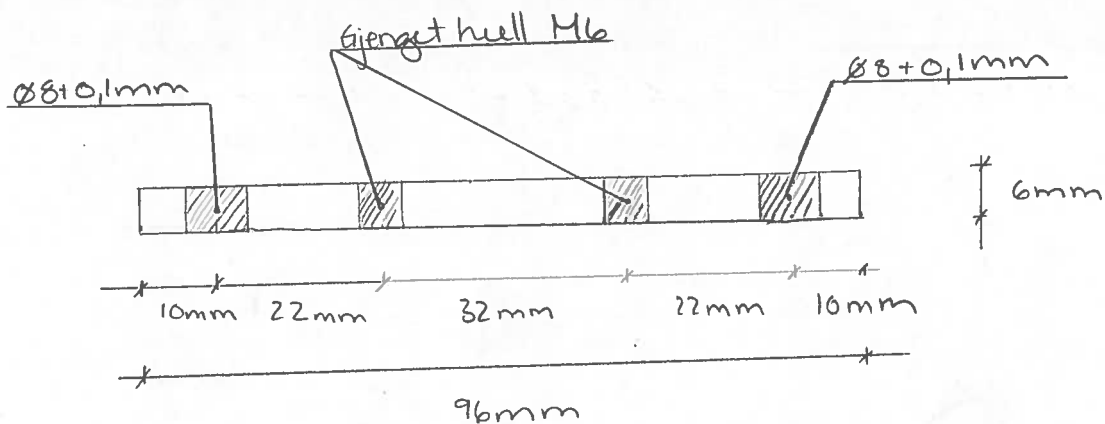

STÅLPLATER S355

Navn: Type 1; Ytre
Ant. 34 stk

Skala 1:1
Str. A4

Snitt B-B:

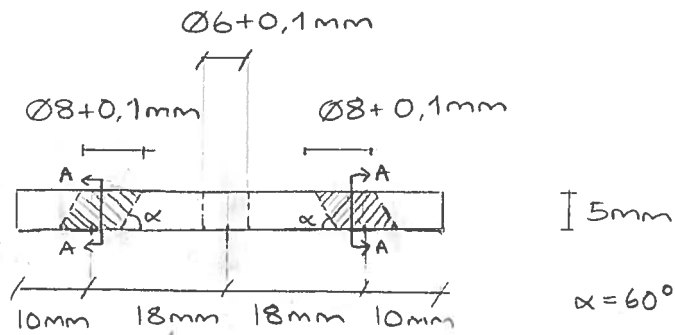

Snitt A-A:

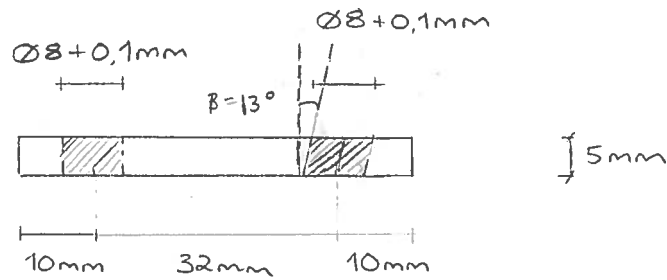

(merknad: hull $\varnothing 6+0,1\text{mm}$ skal ikke vinkles)

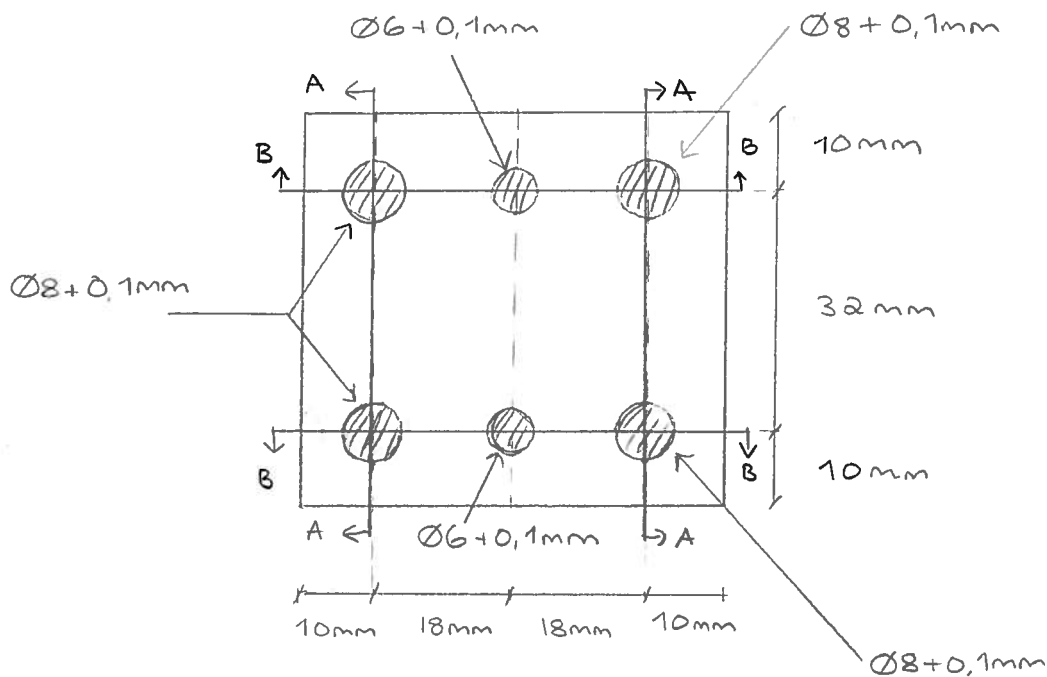

Stålplater S 355

Navn: Type 2, -indre

Skala 1:1

Ant. 34 stk

Str. A4

Snitt B-B:

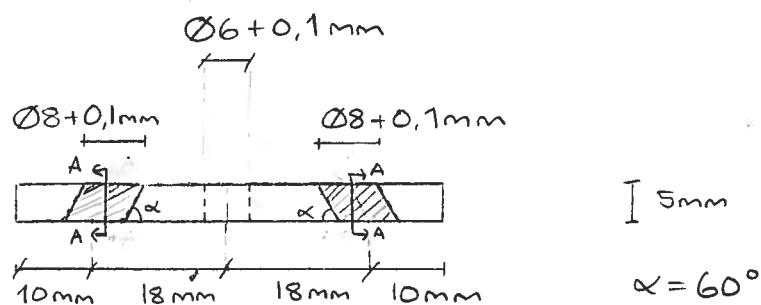

Snitt A-A: (merknad: hull $\varnothing 6 + 0,1 \text{ mm}$ skal ikke vinkles)

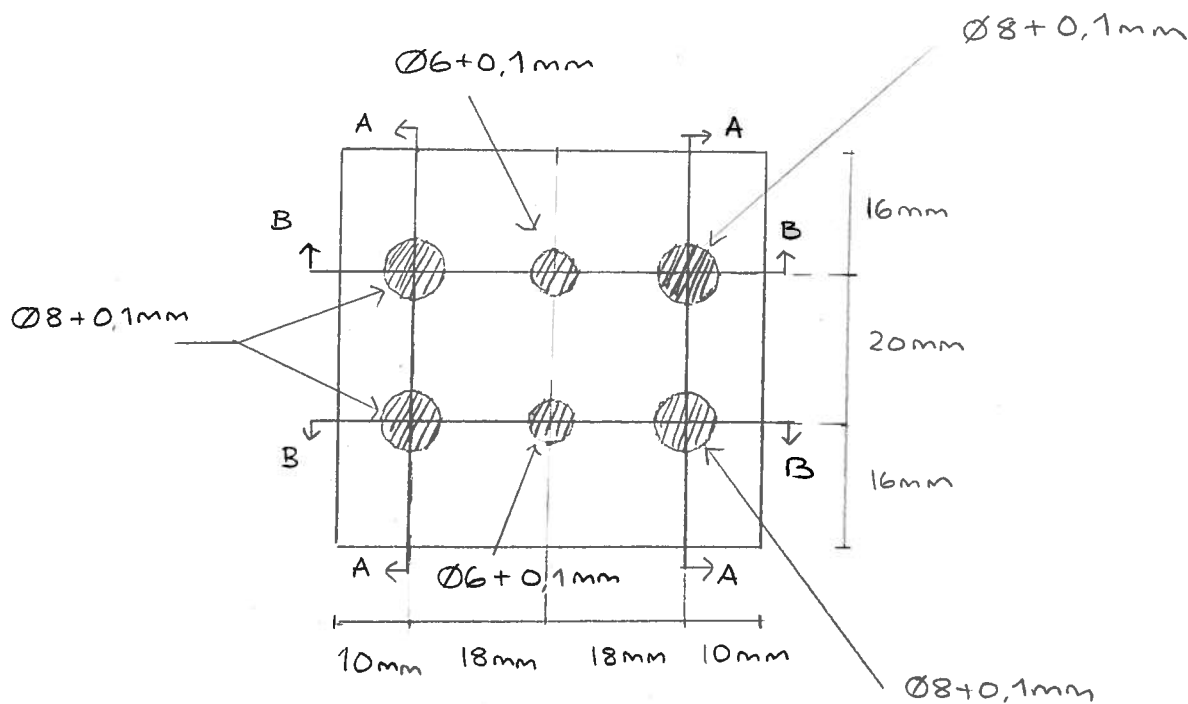
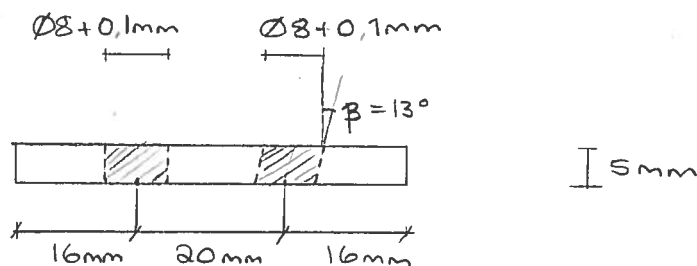

Merk!

Stålplater S355

Navn: Dobbel 1

Skala 1:1

Ant. 4 stk

Str. A4

Snitt B-B:

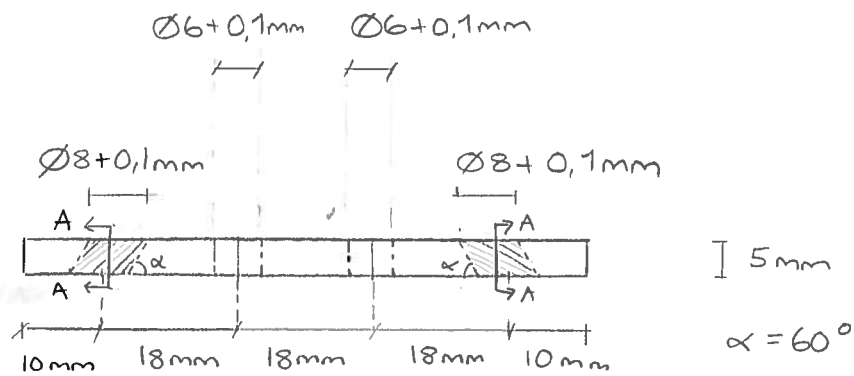

Snitt A-A: (merknad: hull $\varnothing 6+0,1\text{mm}$ skal ikke vinkles)

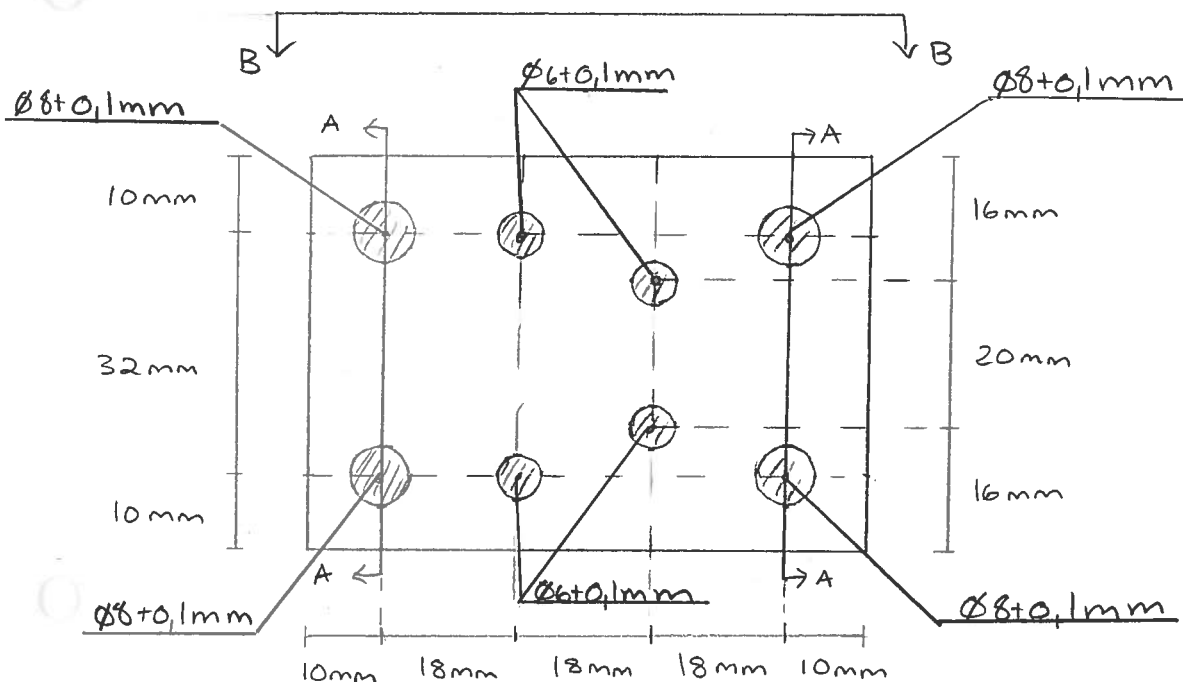
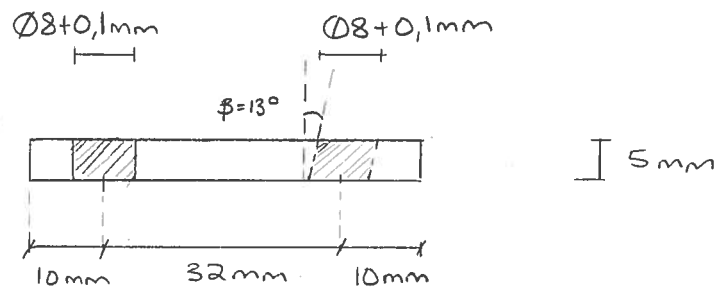

Stålplater S355

Navn: Dobbel 2

Skala 1:1

Antall: 4stk

Str A4

SNITT A-A

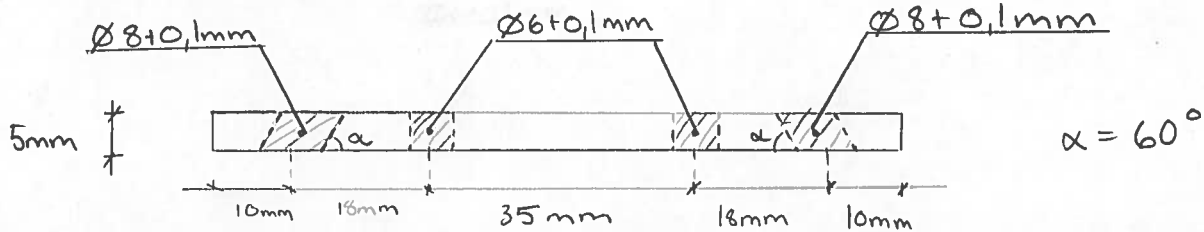

SNITT B-B

(Merk: hull av typen $\varnothing 6 \pm 0,1 \text{ mm}$ skal ikke vinkles)

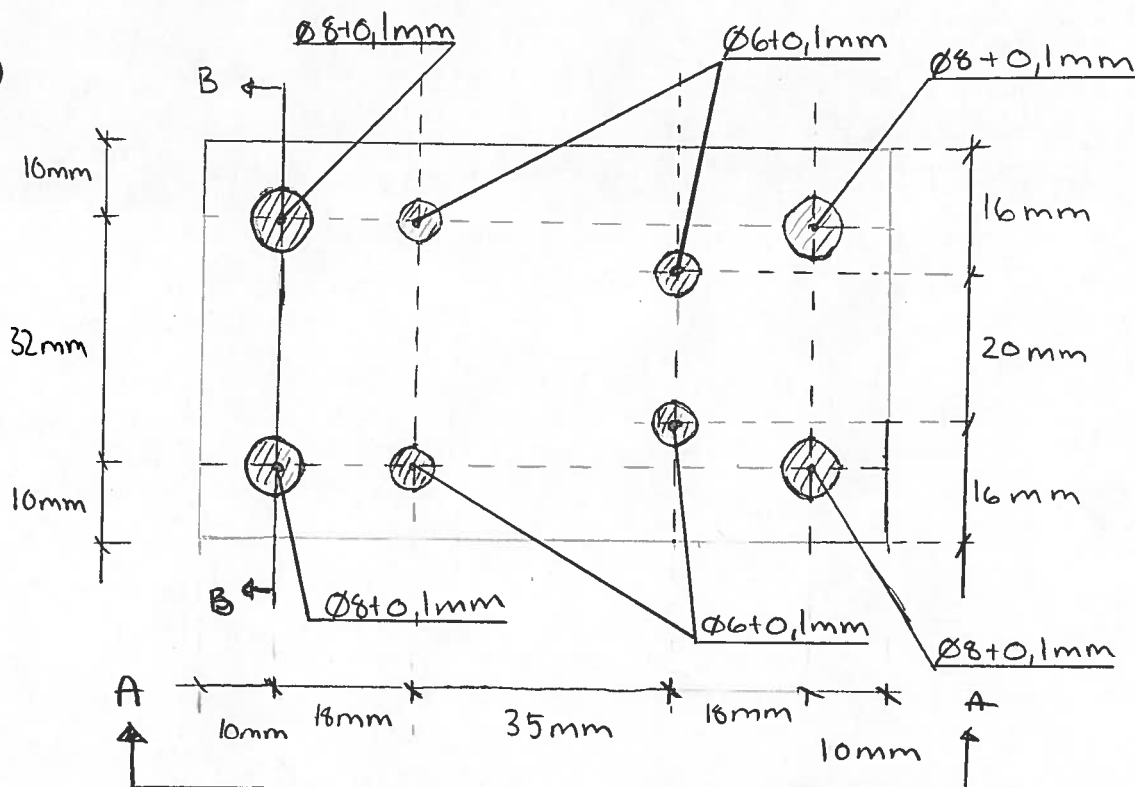
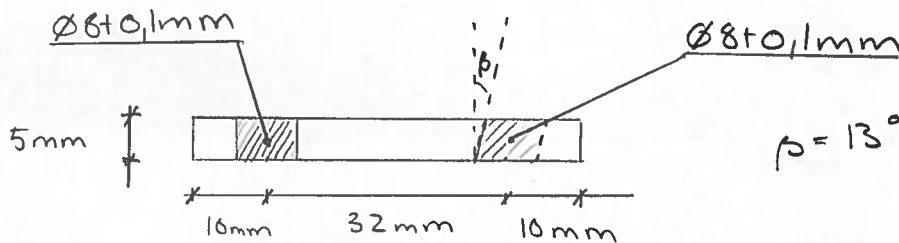

Skala 1:1

Ant. 4 stk

Str. A4

Snitt B-B:

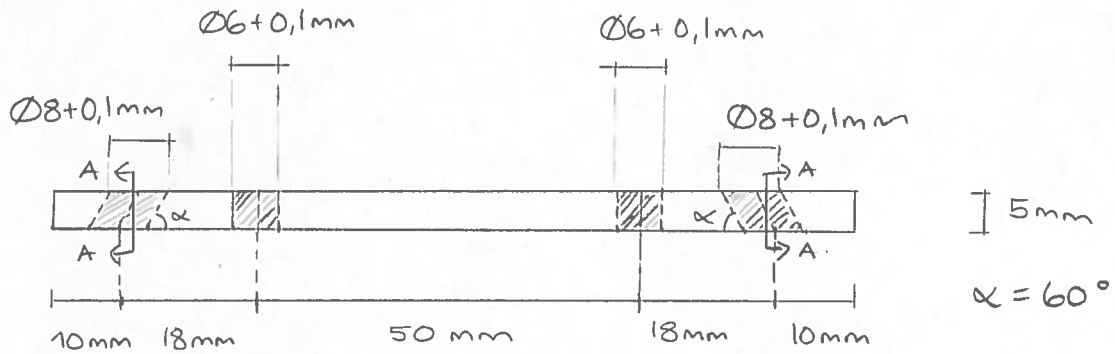

Snitt A-A: (merknad: hull Ø6+1mm skal ikke vinkles)

